



Home Learning

This week has certainly not been without its challenges, however the school has successfully rolled out its remote learning offer. Last week, a few year groups beta tested the system and found that children were very keen to engage and log into the demo lessons. There were a few issues, such as logging into Wonde, however most have been ironed out. Connection rates suggest that the vast majority of pupils can log into live lessons across multiple devices. Ryefield's KS1 and KS2 current engagement rate is 88% of the school population. The school is committed to pushing this engagement rate up into the 90's!

We believe that home learning is not something that either done to, or done for, but rather **done with**. Our teachers remain online and committed to offer support, guidance and encouragement. We hope that this goes some way to taking the pressure that parents are feeling with regard to supporting their child at home. It is gratifying to see so many of you supporting your child's learning, however it is important to remember the following: in order to get things right, sometimes we have to first get them wrong.

We have noticed that - on occasion - parents have interrupted the child's dialogue with the teacher to either correct them or give them the answer. We would ask that you allow them the time and space to think for themselves.

Ryefield's daily schedule include three live lessons, with follow up/finishing off tasks to be done after the lesson. Furthermore, we expect pupils to independently do the following:

- *Independent reading (20 minutes a day)*

- Times Tables practice (20 minutes a day) via [TT Rockstars](#)
- Spelling practice (20 minutes a day) via [Spelling Shed](#)
- Memorising, researching and mind-mapping the facts on their topic Knowledge Organisers (10 minutes a day)

The school's offer exceeds government recommendations for primaries, in truth it is closer to that of secondary schools!

Protocols for learning



We realise that we are venturing into new and uncharted waters. In order to make this a smooth transition we have some protocols that we would like parents and pupils to follow. We hope that this will iron out potential disruptions to lessons and intrusions to teachers evenings and weekends with their own families.

Parent protocol

- Encourage their child to complete assigned work.
- If your child is absent due to sickness, then parents need to call the attendance line and report your student's absence.
- Within school opening hours, communicate concerns with teachers, related service staff, and/or support staff. **It is unacceptable to contact staff at the weekend or after 16.30.** Staff will

respond to email enquiries within 48 hours and within office hours. Persistent offenders will have their accounts suspended. No member of staff is to be contacted via social media.

- Consider appropriate working conditions for your child(ren) to find success throughout the entire school closure period. Support your child(ren)'s participation and engagement in Remote Learning each day.
- Supervise younger siblings so that they do not disturb with the live lesson.
- We ask that parents refrain from recording or taking pictures of their children working online or our teachers delivering lessons. We understand and appreciate that parents want to celebrate and highlight their children's accomplishments and those of their teacher(s). Unfortunately, this may result in the unintended consequence of discouraging our staff from participating in synchronous learning due to the level of exposure and, at times, inappropriate comments that are often posted online. Parents who are found to use their child's account to misuse the remote learning platform will find themselves (and their child) being suspended from Google Classroom.

Pupil protocol

- Pupils must log on each day and complete the work set. When they have finished the work, it should be submitted via Google Classroom or the learning platform being used for the lesson.
- Pupils must complete their designated independent tasks within the specified timescale.
- If a pupil needs support, they should contact their teacher through Google Classroom or via email. [48 office hour window for response]
- All communication with teachers and classmates must be polite and respectful.
- Pupils must not comment and access the message board during anti-social hours, e.g. posting comments and sending messages at 23:30, persistent offenders will be muted and may have their account suspended.
- Pupils must be dressed appropriately; pyjamas, dressing gowns and fancy dress are not acceptable. You will be asked to leave the lesson and instructed to change before re-joining.
- Pupils are allowed to drink during live lessons; however they are not permitted to eat.
- **Pupils will behave in the live lessons as they do in class, failure to behave will mean that they will be removed from the lesson.**

Daily Reading support



As a school, we champion the importance of reading to transform lives. We realise that the current situation presents huge challenges to refreshing your child's home reading books. Last week, we used part of the government's Catch Up Premium to subscribe to Big Cat Collins E-books. This will provide us with access to over 1000 levelled ebooks for use at both school and at home. It is easy to access and straight forward to set up, **the ebook library is perfect for children to practise reading books at the right level at home.**

Next week, we will begin to distribute your child's login details. As with all passwords, we urge parents to either store them in a safe space, or take a photograph of them with your phone's camera.



How to upload work to Google Classroom

How to upload photos to Google Classroom

When your child has completed the task set by the class teacher. Please take a photo and upload the photo by following these steps. This will 'hand in' the work to the class teacher.

Step 1 – Click Create / Add



Step 2 – Click attach file



Step 3 - Select the file(s) you wish to upload

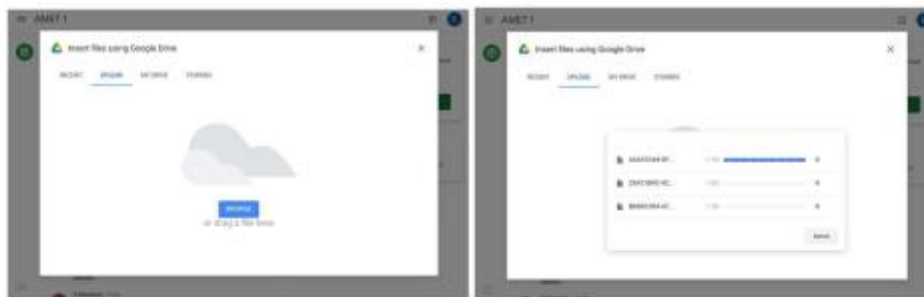

Step 4 – Hand in the work

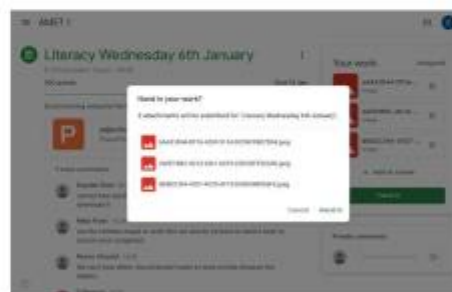

And you are done! 😊

[Oak National Academy](#)



Our class teachers use the resources on the Oak National Academy website to support the delivery of our topics. Should you wish to supplement the literacy and numeracy sessions, parents are welcome to follow their published schedule. The sites hosts almost 10,000 free lessons and resources. Made by teachers, for every teacher and every pupil. Your teacher may direct your child to this site for independent learning task.

[Click on the link above to visit the site.](#)

Access Google Classroom with a £29 Amazon Fire Stick

fire tv stick
Basic Edition



[Click here to learn how to access the resources on a Fire Stick.](#)

Access Google Classroom with a PS4 or Xbox One. **11,000 people have accessed our guide!**

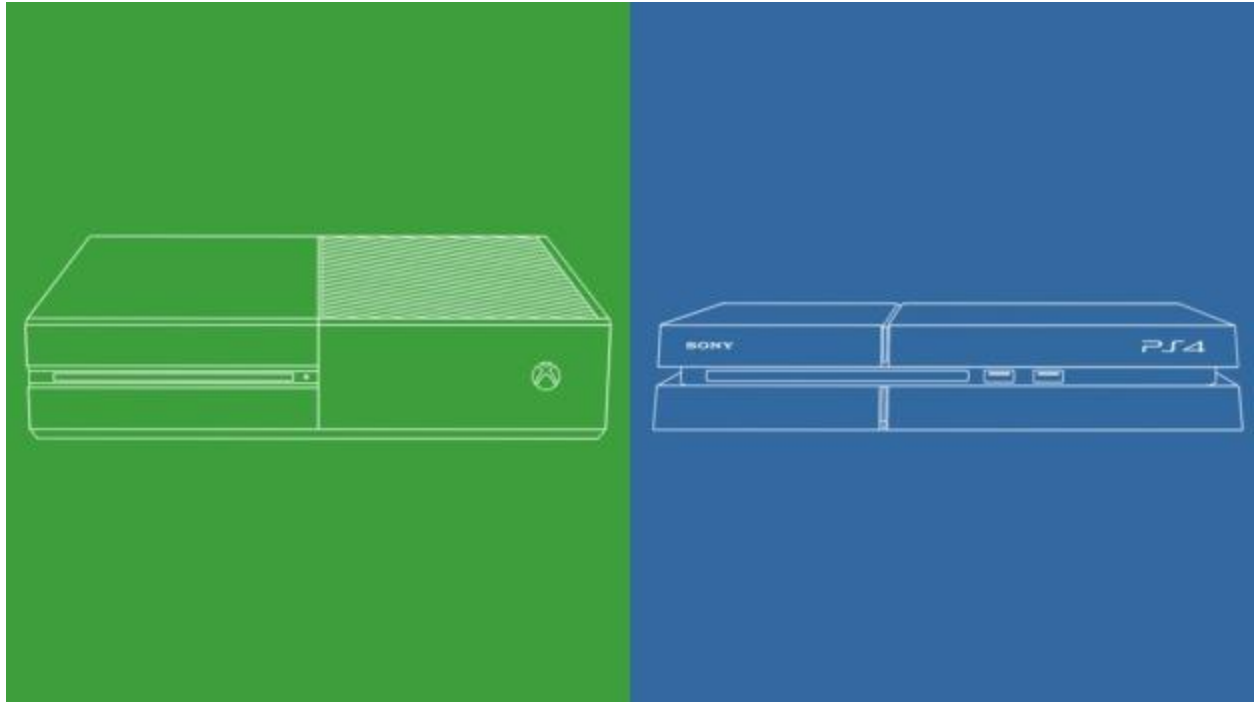

[Click here for a link to a guide on how to access all of the resources on a games console.](#)

Nursery

Remote Learning

Nursery W/C 04/01/2021

Here is an outline of the Remote Learning for this week:

Learning Platform	Activity	Done?
Education City	Literacy - How to Build a Snowman	
	Maths - Ten by ten - Count to 10	
	Maths - Count the objects on the Snowman	
	Science - Rain or Shine	
Google Classroom - Where's My Teddy?	Literacy - 'Where's my Teddy?' by Jez Alborough	
	Maths - Counting using 1:1 correspondence	
	Communication & Language - Rhyming Basket	
	Communication & Language - Positional Language Game	
	Expressive Arts & Design - Teddy craft	
Google Classroom - Phonics: Sound Discrimination	Select a different activity each day	
Google Classroom - Additional Materials	Colouring/ Tracing/ design a teddy	
Google Classroom - Daily Story Time	Daily Story Time with Mrs McGee/ Miss Sheppard	

Please upload any photos of activities and work that you complete with your children to google classroom. I would love to see what your children have been learning at home.

These are challenging times for everyone, remember the 'little and often' approach when working with young children. Don't expect children to be able to concentrate for long periods of time and I can't remind you enough that children LEARN THROUGH PLAY. Quality play is so important, make all of the activities as play based as possible, this will engage and excite your child, this way they'll have fun and won't even realise they're learning.

I have included a range of activities, some require more adult involvement than others. It is important to give your child a range of learning experiences throughout the day, some adult directed, some supported and some independent. This variety helps your child's development. You will find things that need lots of direction initially will shift to become more independent activities over time, as this happens, you can increase the challenge and expectations.

These will be posted on Google Classroom at the beginning of each week:

- Recorded Powerpoint of directed tasks - includes Literacy, Maths, CL & EAD activities
- Daily phonics activities - focussing on listening skills/ rhythm/ rhyme/ alliteration
- Activities set on Education City - Literacy, Maths, Science (dependent on theme of the week)
- Colouring Sheets & counting Sheets
- Fine Motor / pencil control sheets (linked to weekly theme)
- Daily Story Time Videos - from Mrs McGee/Miss Sheppard will be posted and a PE activity on a Thursday

Reception

<p>Personal Social and Emotional</p> <p>We will be learning to:</p> <ul style="list-style-type: none"> *discuss what a good friend is. *share a talent with a peer *discuss emotions and the impact they can have on the emotions of others. *initiate conversations with peers who are not in their close circle of friends. <p>Support your child at home:</p> <ul style="list-style-type: none"> *ask your child to discuss how they are feeling and why *meet a friend outdoors and go for a walk. 	<p>Communication and Language</p> <p>We will be learning to:</p> <ul style="list-style-type: none"> *listen and respond to our peers during discussions around different habitats. *listen to stories and respond with relevant comments, questions & actions. <p>Support your child at home:</p> <ul style="list-style-type: none"> *talk about the day/ experiences you've had 	<p>Physical</p> <p>We will be learning to:</p> <ul style="list-style-type: none"> *use different parts of the body in expressive dance *balance, climb, jump and negotiate space <p>Support your child at home:</p> <ul style="list-style-type: none"> *Visit local parks/ soft play centres *put some music on and have a dance 	<p>Literacy</p> <p>Key texts</p> <p>'Blue Penguin' by Petr Horacek 'The Magic Train Ride' by Sally Crabtree</p> <p>We will be learning to:</p> <ul style="list-style-type: none"> *write labels and captions to go alongside pictures and photographs. *formulate questions and use topic books to find the answers. *write and perform a class poem *create story maps *write simple sentences. <p>Support your child at home:</p> <ul style="list-style-type: none"> *read a variety of different texts with your child. *Visit local libraries *Encourage your child to use the school cursive handwriting.
<p>Key Information</p> <p>Please provide WELLIES for outdoor learning & forest school. Children should be in full school uniform EVERYDAY, except on their PE day when they should come dressed appropriately for PE. Please read with your children for 10 MINUTES PER DAY. Reading books and folders must be in school EVERY FRIDAY. They will be handed out the following Monday.</p> <p>Reminder</p> <p>Chinese New Year Workshop- 12/02/21 Homework is set on a Thursday</p>	<p>Reception Spring Term 1 Polar Regions & Transport</p>		<p>Mathematics</p> <p>We will be learning to:</p> <ul style="list-style-type: none"> *estimate numbers of objects *order numbers 1-20 and beyond. *identify missing numbers in a sequence. *read o'clock and half past on an analogue clock *double numbers to 10 *halve numbers to 20 <p>Support your child at home:</p> <ul style="list-style-type: none"> *play games such as snakes and ladders *encourage your child to read the time on the clock
	<p>Expressive Arts and Design</p> <p>We will be learning to:</p> <ul style="list-style-type: none"> *create artwork through a range of different mediums. *design and construct using a variety of materials. *use musical instruments as a form of expression. <p>Support your child at home:</p> <ul style="list-style-type: none"> *create artwork together *sing songs/ nursery rhymes/read poems together 	<p>Understanding the World</p> <p>We will be learning to:</p> <ul style="list-style-type: none"> *talk about things we have observed about the polar regions. *understand other cultures and celebrations *develop an understanding of the vehicles used by the emergency services <p>Support your child at home:</p> <ul style="list-style-type: none"> *read a book or watch some footage of the polar regions together at home. 	

Please note that the above image details the areas of learning that would have been covered in school. Parents may wish to use this as a reference point to support the activities that can be undertaken at home.

- **These will be posted on Google Classroom at the beginning of each day:**
- Recorded Powerpoint of directed tasks - Over the week this will include 2 Literacy,

- 2 Maths & 1 other Area of Learning, plus Expressive Arts and Design or Fine Motor tasks to complete RWI videos & link to Oxford Owl Activities,
- Education City - Literacy, Maths, Science (dependent on the theme of the week),
- Daily Story Time Videos - from Reception staff and a PE activity once a week
- We have also included a couple of folders on Google Classroom for EYFS parents to dip in and out of: 'Top 10' Activities for Remote Learning with EYFS children (for each area of learning, including Forest School activities)
- Fun things to Try at Home - playdough recipe, homemade paints, science experiments etc

Year 1

Year 1 - Live lesson timetable

	9.00 - 9.10am	9.10 - 10.10am	10.10 - 10.30am	10.35 - 10.45am	10.45 - 11.45am	12.00 - 1.00pm	1.00 - 1.15pm	1.15pm onwards
Monday	Log in/ Register	Literacy	Break	Log in/ Register	Maths	Break/Lunchtime	Log in/ Register	Story & directed tasks
Tuesday	Log in/ Register	Literacy		Log in/ Register	Maths		PE - see links on Google Classroom No 'Live lessons'	
Wednesday	Log in/ Register	Literacy		Log in/ Register	Maths		Log in/ Register	Story & directed tasks
Thursday	Log in/ Register	Literacy		Log in/ Register	Maths		Log in/ Register	Story & directed tasks
Friday	Log in/ Register	Literacy		Log in/ Register	Maths		Log in/ Register	Story & directed tasks

Directed tasks - The class teacher will instruct your child to complete an independent task based on either - Science, Geography, History, Art, PSHE etc and this time should also be used to watch the Read Write Inc. (RWI) lesson. The work should then be uploaded to Google Classroom.

* Also available via Google Classroom:- Information for parents. In this area we will add any useful information e.g. 'How to upload photos to Google Classroom' - Useful Resources. This area contains additional resources to support your child's learning e.g. 'Word mat', 'Number-lines', 'Lined/Squared paper printables'. We will add any extra resources we may think are useful as time progresses.

* Each week there will also be a new Education City task and a new set of spellings on Spelling Shed for your child to learn. This is continuation of the work set each week as homework - before Christmas.

* PE lesson activities can be found under each 'Lockdown week'. They are dated and information is attached within that sub-heading.

Please ensure your child logs in on time and if you are having issues please let us know and we will do our best to assist you. The afternoon sessions will be live for the first half hour or so when the class teacher will read a story and introduce the directed tasks. After they have introduced the task, your child will be required to carry out the tasks themselves.

Year 2

Year 2 - Live lesson timetable

	9.00 - 9.10am	9.10 - 10.10am	10.10 - 10.30am	10.35 - 10.45am	10.45 - 11.45am	12.00 - 1.00pm	1.00 - 1.15pm	1.15pm - 3.00
Monday	Log in/ Register	Literacy	Break	Log in/ Register	Maths	Break/Lunchtime	PE - see links on Google Classroom No 'Live lessons'	
Tuesday	Log in/ Register	Literacy		Log in/ Register	Maths		Log in/ Register	Story & directed tasks
Wednesday	Log in/ Register	Literacy		Log in/ Register	Maths		Log in/ Register	Story & directed tasks
Thursday	Log in/ Register	Literacy		Log in/ Register	Maths		Log in/ Register	Story & directed tasks
Friday	Log in/ Register	Literacy		Log in/ Register	Maths		Log in/ Register	Story & directed tasks

Directed tasks – The class teacher will instruct your child to complete an independent task based on either – Science, Geography, History, Art, PSHE etc and this time should also be used to watch the Read Write Inc. (RWI) phonic lesson. The work should then be uploaded to Google Classroom.

Year 3

Year 3 - Online lesson delivery.

Year 3	9-9.10	9.10 -10.10	Break	10:35	10.45 - 11.45	Lunch	1-1.10	1.10 - 1.35
Mon	Log on and reg	LITERACY		Log on and Reg	Numeracy		Log on and Reg	SCIENCE Story @2.30
Tues		LITERACY			Numeracy			SCIENCE Story @2.30
Wed		LITERACY			Numeracy			PPA - PSHE + P.E via Joe Wicks
Thur		LITERACY			Numeracy			GUIDED READING SPa6 Story @2.30
Fri		LITERACY			Numeracy			ART Story @2.30

Please upload photos of any of the work you complete on google classroom.

We will be starting with our Science topic which is Rocks and Soils before moving onto our Geography topic. This should give you time to do any extra research you may wish to do. We will continue to add a few extra resources onto google classroom for you to use and complete if you feel you would like some extra activities to do. There will also be activities on Education City and don't forget keep on top of your tables on TTRS.

Year 4

K52	9-9.10	9.10 -10.10		10:50	11.00 - 12.00		1-1.10	1.10 - 1.35	
Mon	Log on And reg	Mr White delivers LITERACY		Log on And reg	Mr Brill delivers Numeracy		Log on And reg	Mr White reads to Year group And directs pm task. GEOGRAPHY	
Tues	Log on And reg	Mr White delivers LITERACY		Log on And reg	Mr Brill delivers Numeracy		Log on And reg	Mr Brill reads to Year group And directs pm task. SCIENCE	
Wed	Log on And reg	Mr White delivers LITERACY			Mr Brill delivers Numeracy		Log on And reg	Offline learning -Computing Via Education city + P.E via Focus-Fit	
Thur	Log on And reg	Mr White delivers LITERACY			Mr Brill delivers Numeracy		Log on And reg	Mr White reads to Year group And directs pm task. R.E	
Fri	Log on And reg	Mr White delivers LITERACY			Mr Brill delivers Numeracy		Log on And reg	Mr Brill reads to Year group And directs pm task. ART	

Year 4 will teach remotely via Google meet. The links will be posted daily before each lesson starts. We will be using a mix of live flip-charts, PowerPoint, mymaths, Oak academy and education city to facilitate a weekly timetable that closely reflects the one Year 4 undertook whilst at school.

We will post the necessary worksheets for each lesson the day before giving you ample time to find and print. (If you are able). The worksheets we post are to be completed in the 'live' lesson and not prior. The set tasks can be completed on sheets of plain or lined paper and the online sheets used for reference.

Year 5

Year 5 Remote learning timetable – January 2021

Day	9am – 9.10am	9.10am – 10.10am	10.10am – 10.30am	10.35am – 10.45am	10.45am – 11.45am	12pm – 1pm	1pm – 1.15pm	1.15pm	1.30pm Topic – science/History/ Geography
Monday	Log on to Google classroom/google meet & registration	Maths P – Mrs Thornhill F – Mrs Mander	Break	Log on to Google classroom/google meet & registration	Literacy/PoR P – Mrs Thornhill F – Mrs Mander Mrs Hope's group	Lunch	Log on to Google classroom/google meet & registration	Story session & directed task	Topic & directed independent task
Tuesday	Log on to Google classroom/google meet & registration	Maths P – Mrs Thornhill F – Mrs Mander	Break	Log on to Google classroom/google meet & registration	Literacy/PoR P – Mrs Thornhill F – Mrs Mander Mrs Hope's group	Lunch	Log on to Google classroom/google meet & registration	Story session & directed task	Topic & directed independent task
Wednesday	Log on to Google classroom/google meet & registration	Maths P – Mrs Thornhill F – Mrs Mander	Break	Log on to Google classroom/google meet & registration	Literacy/PoR P – Mrs Thornhill F – Mrs Mander Mrs Hope's group	Lunch	Log on to Google classroom/google meet & registration	Story session & directed task	Topic & directed independent task
Thursday	Log on to Google classroom/google meet & registration	Maths P – Mrs Thornhill F – Mrs Mander	Break	Log on to Google classroom/google meet & registration	Literacy/PoR P – Mrs Thornhill F – Mrs Mander Mrs Hope's group	Lunch	Log on to Google classroom/google meet & registration	Story session & directed task	Topic & directed independent task
Friday	Log on to Google classroom/google meet & registration	Maths P – Mrs Thornhill F – Mrs Mander	Break	Log on to Google classroom/google meet & registration	Literacy/PoR P – Mrs Thornhill F – Mrs Mander Mrs Hope's group	Lunch	Log on to Google classroom/google meet & registration	Story session & directed task	Independent work – Joe Wickes (You Tube/PE) Ed City – (Science Content)

Year 5 teachers will be using 'Google Meet' and sending individual classes invites to join for each session, all work will be uploaded on to 'Google classroom'. Children will also be expected to use sites such as My Maths and Education City.

Year 6

Year 6 2020/2021

	9.00 – 10.10	Break	10.45 – 11.55am	Lunch 12.00 – 1.00	1.00- 1.25	1.30
Monday	Literacy		Mathematics		Class Book	Topic/Science
Tuesday	Literacy		Mathematics		Class Book	Topic/Science
Wednesday	Literacy		Mathematics		Class Book	Topic/Science
Thursday	Literacy		Mathematics		Class Book	Topic/Science
Friday	Literacy Vocabulary Spelling Test		Mathematics		Class Book	Topic/Science

Your child will join the English and Maths group that they were set in school. Each group has its own classroom. At the designated time they need to click the link at the top of the classroom and join their teacher and their classmates.

The afternoon session will be based in their registration classes; they should click the link at the top for their class: Curie or Churchill.

[Further learning resources are available from Ryefield Primary School](#)



Click [here](#) to access the online learning resources available on the school's website.